

Baoli

EP 20-111 / EP 20-111Li

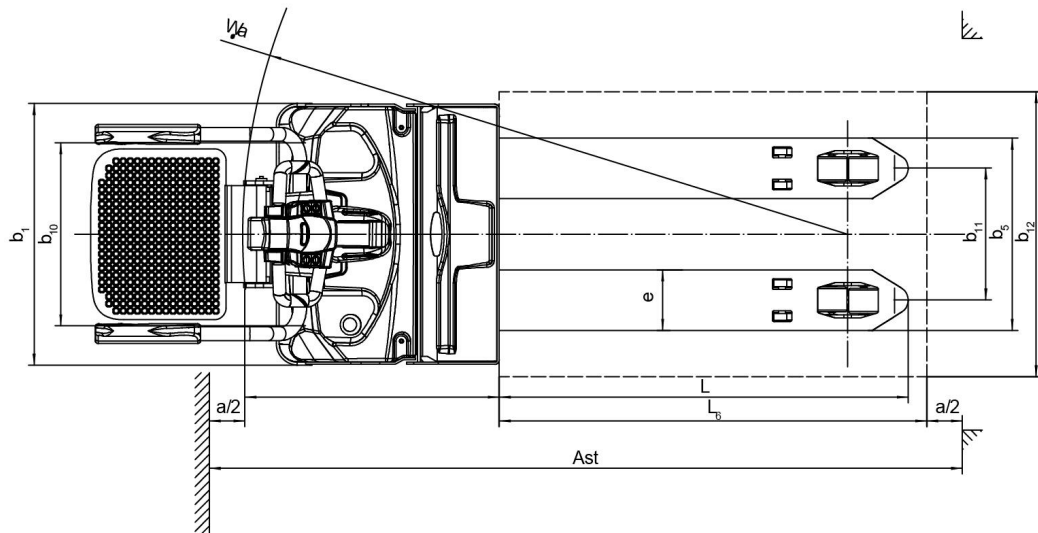

1.1	Manufacturer		KION BAOLI	KION BAOLI
1.2	Manufacturer's type designation		EP 20-111	EP 20-111Li
1.3	Drive: electric, diesel, petrol, fuel gas		Electric	Electric
1.4	Operator type: hand, pedestrian, standing, seated, order-picker		Pedestrian	Pedestrian
1.5	Rated capacity / Rated load	Q (t)	2,0	2,0
1.6	Load centre distance	c (mm)	600	600
1.8	Load distance, centre of drive axle to fork	x (mm)	916	916
1.9	Wheelbase	y (mm)	1418	1418
2.1	Service weight	Kg	690	690
2.2	Axle loading, laden front/rear	Kg	1076/1614	1076/1614
2.3	Axle loading, unladen front/rear	Kg	556/134	556/134
3.1	Tyres: solid rubber, superelastic, pneumatic, polyurethane		PU	PU
3.2	Tyre size, front		Ø 230x75	Ø 230x75
3.3	Tyre size, rear		Ø 85x70	Ø 85x70
3.4	Additional wheels (dimensions)		Ø130x60	Ø130x60
3.5	Wheels, number front/rear (x = driven wheels)		1+2/4	1+2/4
3.6	Tread, front	b10 (mm)	510	510
3.7	Tread, rear	b11 (mm)	370/430/515	370/430/515
4.4	Lift	h3 (mm)	125	125
4.9	Height drawbar in driving position min/max	h14 (mm)	1150/1470	1150/1470
4.15	Height, lowered	h13 (mm)	85	85
4.19	Overall length	l1 (mm)	1860	1860
4.20	Length to face of forks	l2 (mm)	710	710
4.21	Overall width	b1/b2 (mm)	730	730
4.22	Fork dimensions ISO 2331	s/e/l (mm)	55x170x1150	55x170x1150
4.25	Distance between fork-arms	b5 (mm)	540/685	540/685
4.32	Ground clearance, centre of wheelbase	m2 (mm)	30	30
4.34.1	Aisle width for pallets 1000 x 1200 crossways	Ast (mm)	1984	1984
4.34.2	Aisle width for pallets 800 x 1200 lengthways	Ast (mm)	2184	2184
4.35	Turning radius	Wa (mm)	1700	1700
5.1	Travel speed, laden/unladen	km/h	9/12	9/12
5.2	Lift speed, laden/unladen	m/s	0,023/0,031	0,023/0,031
5.3	Lowering speed, laden/unladen	m/s	0,043/0,032	0,043/0,032
5.8	Max gradeability, laden/unladen	%	8/16	8/16
5.10	Service brake		Electromagnetic	Electromagnetic
6.1	Drive motor rating S2 60 min	kW	2.5	2.5
6.2	Lift motor rating at S3 15%	kW	2.2	2.2
6.3	Battery according to DIN 43531/35/36 A, B, C, no		-	-
6.4	Battery voltage/nominal capacity K5	V/Ah	24 V / 210 Ah	24 V / 205 Ah Li-ion
6.5	Battery weight	kg	190	62
6.6	Energy consumption according to VDI cycle	kWh/h	0.38	0.38
8.1	Type of drive unit		AC	AC
10.7	Sound pressure level at driver's seat	dB (A)	74	74

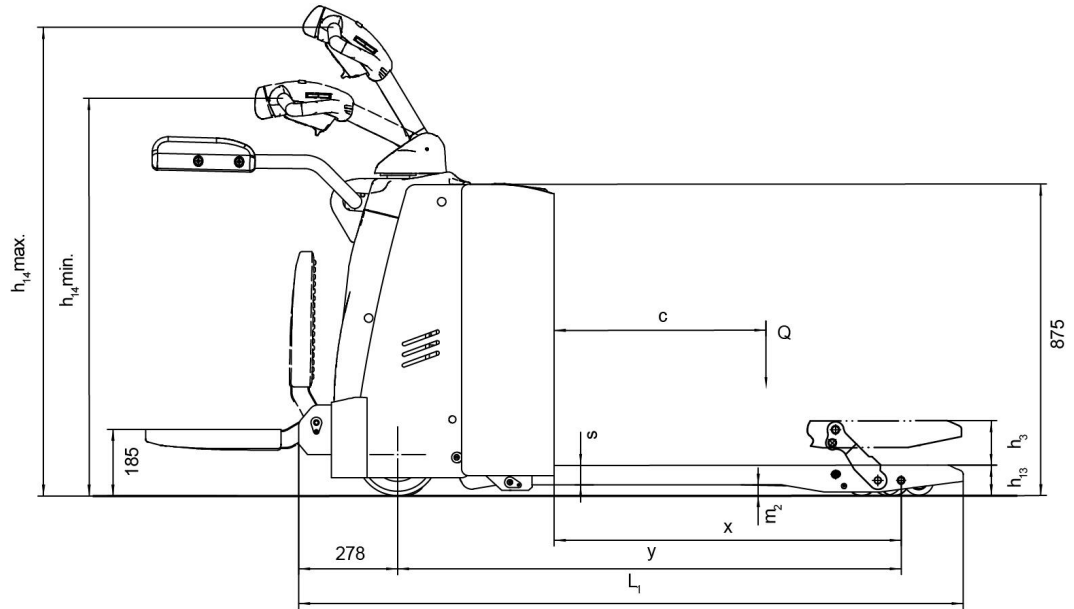

EP 20-111 / EP 20-111Li



The Baoli EP 20-111 pallet truck is available with a load capacity of 2000 kg, foldable platform, and arm guard. This truck is specifically designed for moving loads on medium and long distances. Very manoeuvrable, the EP 20-111 has an ergonomic tiller linked to an electric steering system. This central device increases safety and reduces operator fatigue during all operations.

With a maximum speed of 12 km/h unloaded, and 9 km/h loaded, the EP 20-111 offers great benefits compared to pedestrian pallet trucks. It allows to significantly speed up load movements and reduce moving times in medium and large warehouses.

Technology and features

- ✓ Maximum speed up to 12 km/h
- ✓ Electronic steering system
- ✓ Heavy-duty arm guards
- ✓ Solid chassis and platform
- ✓ Full metal engine and battery covers
- ✓ Forks with an overall width of 540 or 685 mm available
- ✓ Fork length up to 2400 mm (2 pallets)
- ✓ Up to 345 Ah lead-acid battery
- ✓ 24 V / 205 Ah lithium-ion battery
- ✓ Electromagnetic parking brake

The EP 20-111 can be equipped with three different lead-acid batteries: either a 210 Ah or a 280 Ah battery for standard work shifts, and 345 Ah to last for a whole working day.

The EP 20-111 model is also available with a 24 Volt / 205 Ah lithium-ion battery. Lithium-ion batteries offer numerous advantages: they allow for short interim charges, ensuring increased truck availability; they are virtually maintenance-free and eliminate the risk of hazardous gases during charging.

The pallet truck can be customised in many ways, including forks with a length up to 2400 mm to move 2 pallets at a time.

